

Installation sheet Refer to user manual for details

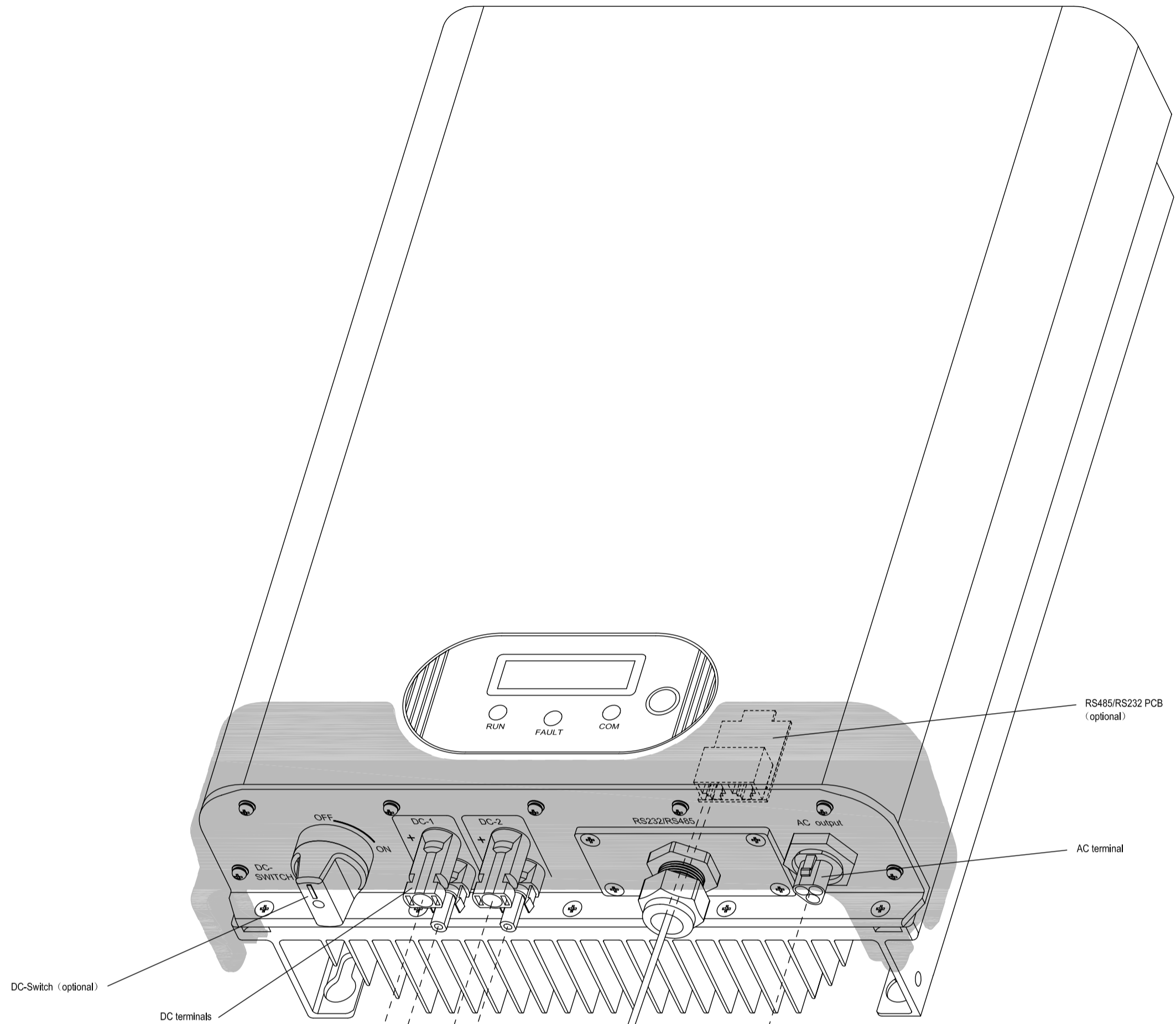

Sequence of connecting:
 De-energize all energy sources
 1.Connect AC grid wiring
 2.Connect Solar wiring
 3.Switch on dc-switch
 4.Switch on ac-switch

Wiring solar connection:
 Connect MC4 string(s) connectors to DC terminals
 or
 connect string(s) to solar breaker

⚠ Breaker must have a minimum rating of 600V dc and 15A cont.
 ⚠ Serial fusing may be required.
 ⚠ Solar irradiated panel generates high voltage.

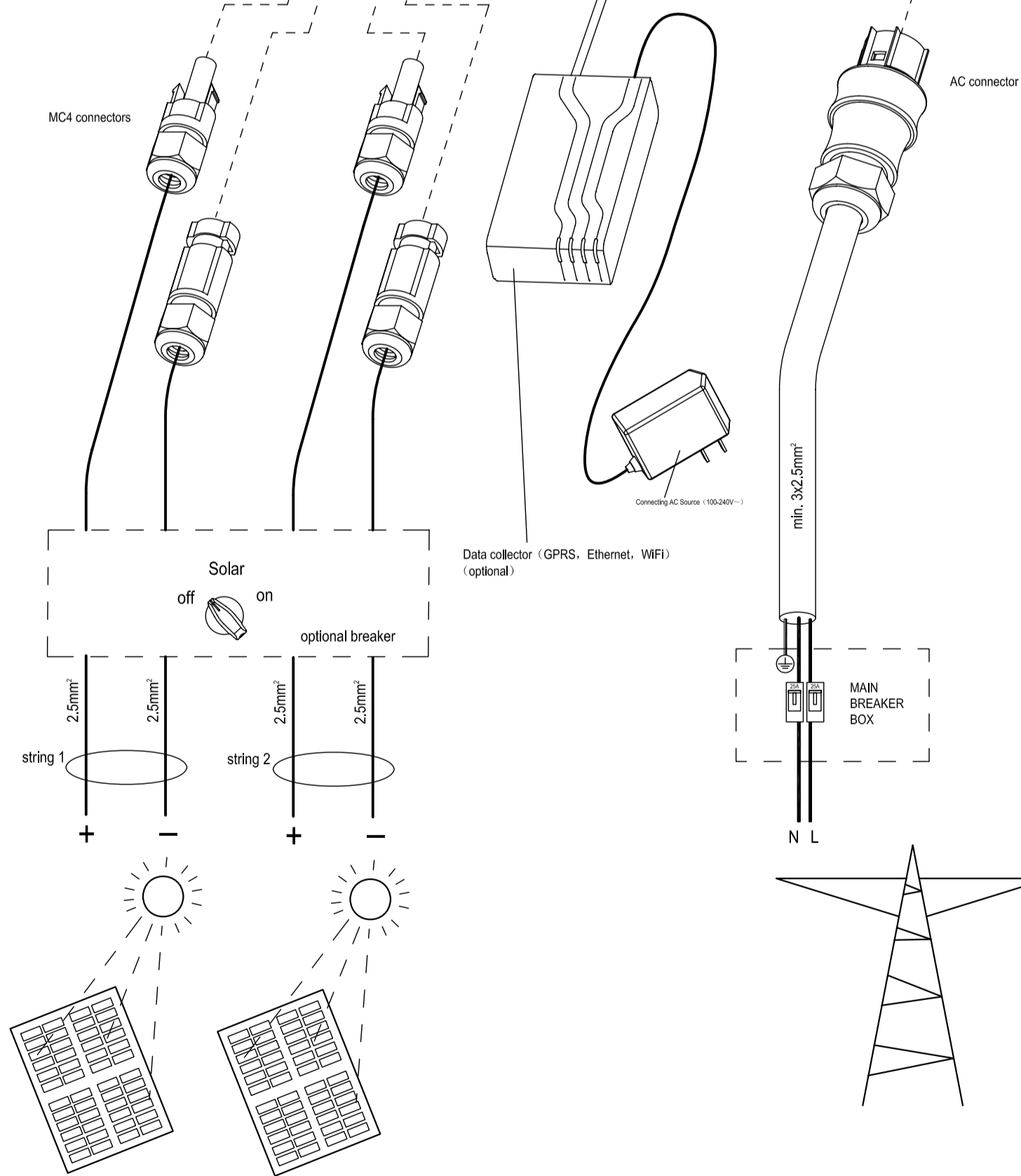

Wiring grid connection:

⚠ Turn off the main breaker in the main utility breaker box

- 1.Connect the AC grid ground wire to the AC connector labelled ⊕
- 2.Connect the AC grid L wire to the AC connector labelled L
- 3.Connect the AC grid N wire to the AC connector labelled N
- 4.Then connect the AC connector to AC terminal on inverter
 (Refer to user manual page 19-20 in detail)

Verify that all connections are correctly wired and properly torqued (.min.1.0Nm Max1.2Nm)

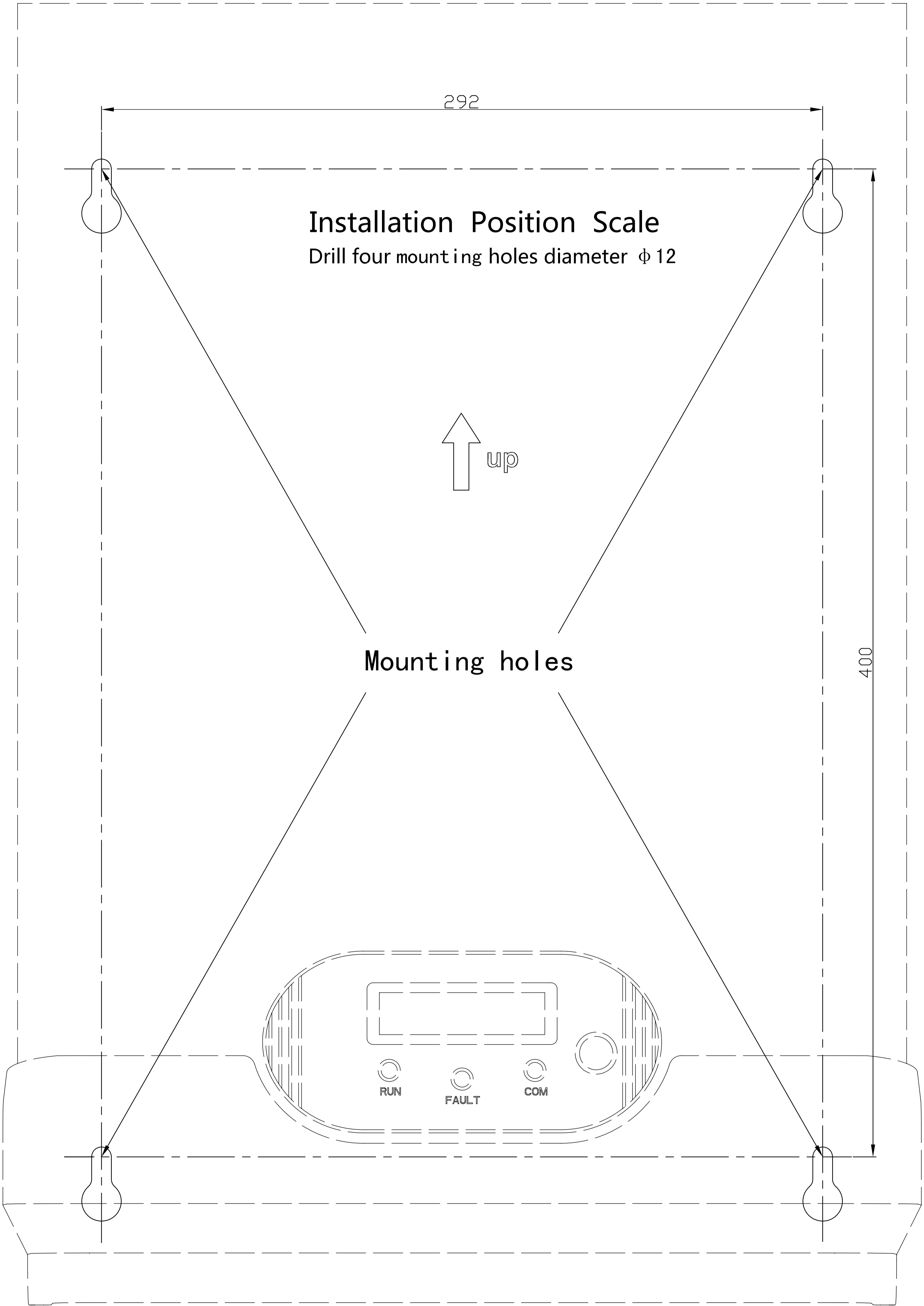

Installation Position Scale

Drill four mounting holes diameter $\phi 12$

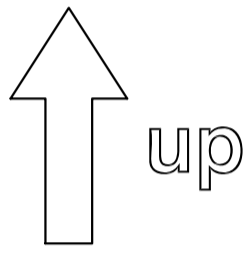

Mounting holes

RUN

FAULT

COM